

Upgrade to CopperLine electrodes!

CopperLine™ electrodes provide the performance and quality you need to get the job done at the lowest possible overall cost. Combined with Centricut shields and tips, we offer the best value and quality combination on the market!

Centricut product for Thermal Dynamics®

Merlin 3000, 6000®



Reduce consumable inventory for your Maximizer 300 torch

Two redesigned Centricut electrodes cover applications requiring five different OEM electrodes

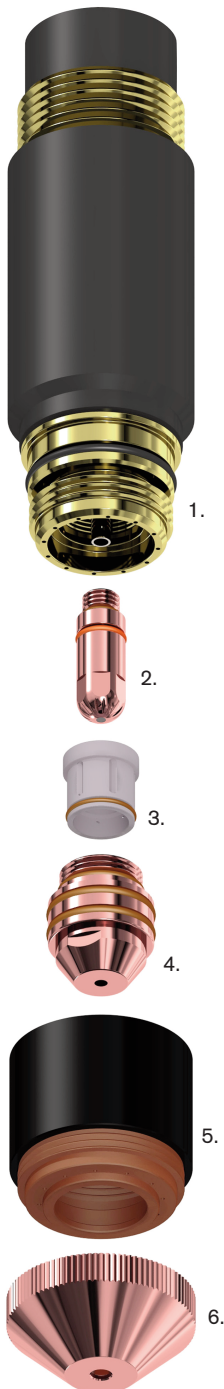
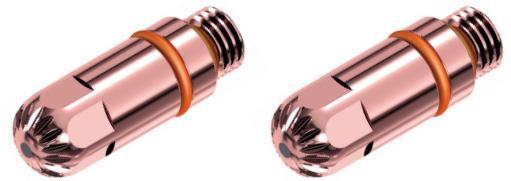

Part number	Reference	Description
1. T55-410	9-6410	Maximizer 300 torch body
2. C55-718	20-1018, 20-1015	CopperLine electrode, Air/O ₂ , 50 – 300 amp
C55-710	20-1010, 20-1016, 20-1021	CopperLine electrode, Air/O ₂ , 50 – 300 amp
T55-023	20-1023	Electrode, N ₂ , 50 – 300 amp
T55-025	20-1025	Electrode, ArH ₂ , 100 – 300 amp
3. C55-008	20-0008	Gas distributor, 50 – 225 amp
T55-009	20-1009	Gas distributor, 300 amp
4. C55-030	20-1030	Tip, 50 amp
C55-031	20-1031	Tip, 100 amp
C55-032	20-1032	Tip, 150 amp
C55-033	20-1033	Tip, 225 amp
C55-034	20-1034	Tip, 300 amp
T55-029	20-1029	Shield cup body, underwater
5. C55-002	20-1002	Shield cup body
6. C55-803	20-1003	Shield, 50 amp
C55-804	20-1004	Shield, 100 – 225 amp
T55-028	20-1028	Shield, 100 – 300 amp, underwater
C55-805	20-1005	Shield, 300 amp

Centricut, CopperLine and Hypertherm are trademarks of Hypertherm, Inc., and may be registered in the United States and/or other countries. All other trademarks are the property of their respective owners. Hypertherm is in no way affiliated with Thermal Dynamics.

© 8/09 Hypertherm, Inc.

881320

Hypertherm®

Hypertherm, Inc.
Hanover, NH 03755 USA
603-643-3441 Tel

Hypertherm (S) Pte Ltd.
Singapore 349567
65 6 841 2489 Tel

Hypertherm (Shanghai)
Trading Co., Ltd.
PR China 200052
86-21 5258 3330 /1 Tel

Hypertherm Europe B.V.
4704 SE Roosendaal, Nederland
31 165 596907 Tel

Hypertherm Brasil Ltda.
Guarulhos, SP - Brasil
55 11 2409 2636 Tel

www.hypertherm.com

**Contact your Hypertherm distributor
or call 1-800-752-7623 for the
location nearest to you.**